

Mouse – Slowing it Down

Many people think they can't use a computer because they can't use a mouse.

For many of these people the cause of their difficulty is the speed the pointer travels on the screen when they move the mouse across their desk. This speed can easily be reduced and suddenly the mouse is far more manageable.

This skillsheet shows you how to slow down your mouse.

Please note: If you have bought a different mouse and/or installed a different mouse driver then the options may look slightly different to those shown here.

Slowing Down Your Mouse

- Using the mouse, Click the **Start menu** button or alternatively you can press the **Windows logo key** (located between the **Ctrl** and **Alt** keys) on your keyboard - or **Ctrl + Esc**.
- Click on **Control Panel** or press the letter **C** on the keyboard.
- Double click on **Mouse** or press the **M** key repeatedly until **Mouse** is highlighted and then press **Enter**.
- The **Mouse Properties** page should be displayed (see Fig. 1).
- Click on the **Pointer Options** tab or press **Control + Tab** until the **Pointer Options** tab is at the front.
- Click and drag the slider underneath **Select a pointer speed**, or press **Alt + C** and use the **left and right arrow keys** to adjust the pointer speed.
- Click **OK** or press **Enter** to confirm your choice and exit the **Mouse Properties**.

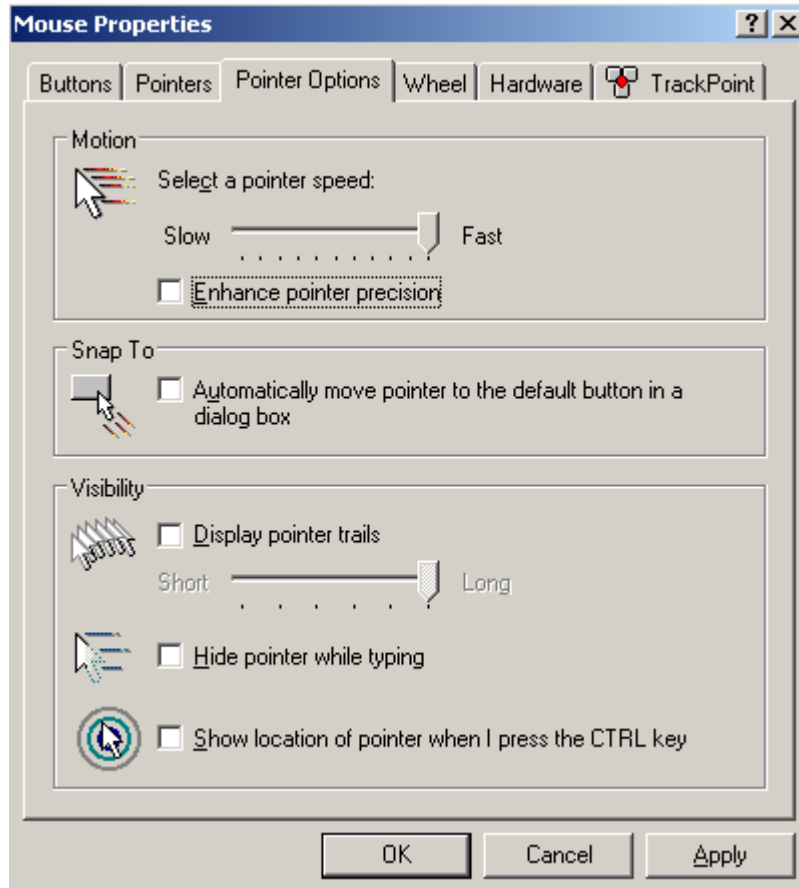

Fig.1